

MODEL : SSEL

WORKING PRESSURE : 16BAR
 WORKING TEMPERATURE : -50°C TO +450°C

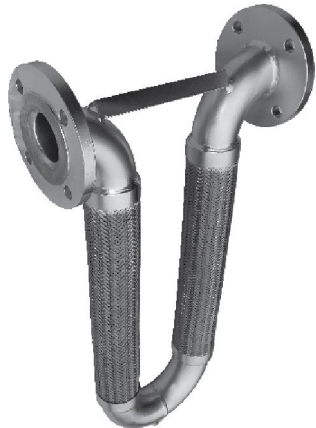

PIPE SIZE	MOVEMENT	WELD ENDS						THREAD ENDS				GROOVED ENDS				FLANGED ENDS						
		MODEL SSEL-W		SPRING RATE	PN SINGLE BRAID	PN DOUBLE BRAID	MODEL SSEL-T		SPRING RATE	PN SINGLE BRAID	PN DOUBLE BRAID	MODEL SSEL-G		SPRING RATE	PN SINGLE BRAID	PN DOUBLE BRAID	MODEL SSEL-F		SPRING RATE	PN SINGLE BRAID	PN DOUBLE BRAID	
		A	B	LBS.			A	B	LBS.			A	B	LBS.			A	B	LBS.			
DN15	±40mm ±100mm	152.40 228.60	330.20 431.80	45	75.70	121.13	304.80 381.00	330.20 431.80	45	75.70	121.13											
DN20	±40mm ±100mm	133.35 234.95	330.20 457.20	47	55.77	89.23	311.15 387.35	330.20 457.20	47	55.77	89.22											
DN25	±40mm ±100mm	152.40 254.00	381.00 508.00	53	40.21	64.37	304.80 406.40	381.00 508.00	53	40.21	64.37											
DN30	±40mm ±100mm	190.50 273.05	406.40 533.40	66	37.39	59.86	342.90 425.45	406.40 533.40	66	37.39	59.86											
DN40	±40mm ±100mm	228.60 292.10	431.80 584.20	70	33.24	53.17	381.00 444.50	431.80 584.20	70	33.24	53.17											
DN50	±40mm ±100mm	304.80 355.60	482.60 635.00	78	35.21	52.82	457.20 508.00	482.60 635.00	78	35.21	52.82	457.20 508.00	482.60 635.00	78	35.21	52.82	317.50 368.30	482.60 635.00	78	35.21	52.82	
DN65	±40mm ±100mm	381.00 393.70	533.40 711.20	83	27.25	43.59	533.40 546.10	533.40 711.20	83	27.25	43.59	533.40 546.10	533.40 711.20	83	27.25	43.59	393.70 406.40	533.40 711.20	83	27.25	43.59	
DN80	±40mm ±100mm	457.20 457.20	584.20 762.00	90	20.28	30.35	660.40 660.40	584.20 762.00	90	20.28	30.35	609.60 609.60	584.20 762.00	90	20.28	30.35	469.90 469.90	584.20 762.00	90	20.28	30.35	
DN100	±40mm ±100mm	609.60 609.60	711.20 889.00	120	16.34	26.13	812.80 812.80	711.20 889.00	120	16.34	26.13	762.00 762.00	711.20 889.00	120	16.34	26.13	622.30 622.30	711.20 889.00	120	16.34	26.13	
DN125	±40mm ±100mm	762.00 762.00	812.80 1016.00	186	13.45	21.55						914.40 914.40	812.80 1016.00	186	13.45	21.55	774.70 774.70	812.80 1016.00	186	13.45	21.55	
DN150	±40mm ±100mm	914.40 914.40	939.80 1168.40	202	11.62	18.59						1066.80 1066.80	939.80 1168.40	202	14.93	18.59	927.10 927.10	939.80 1168.40	202	11.62	18.59	
DN200	±40mm ±100mm	1219.20 1219.20	1219.20 1473.20	260	14.93	16.20						1422.40 1422.40	1219.20 1473.20	260	13.62	16.20	1231.90 1231.90	1219.20 1473.20	260	14.93	19.37	
DN250	±40mm ±100mm	1524.00 1524.00	1397.00 1701.80	383	12.32	14.08						1727.20 1727.20	1397.00 1701.80	383	12.32	14.08	1536.70 1536.70	1397.00 1701.80	383	12.32	19.01	
DN300	±40mm ±100mm	1828.80 1828.80	1600.20 1879.60	390	11.27	13.24						2032.00 2032.00	1600.20 1879.60	390	11.27	13.24	1841.50 1841.50	1600.20 1879.60	390	11.27	15.49	
DN355	±40mm ±100mm																2146.30 2146.30	1803.40 2044.70	706	7.75	8.80	
DN400	±40mm ±100mm																2451.10 2451.10	1993.90 2324.10	900	7.75	11.97	
DN455	±40mm ±100mm																2755.90 2755.90	2197.10 2540.00	1000	6.00	10.56	

ALL DIMENSIONS ARE IN MM

CONSTRUCTION
 ENDS: CARBON STEEL
 END FITTINGS: FLANGED/WELD/GROOVED/THREAD
 HOSE & BRAID: STAINLESS STEEL
 90° ELBOW: C/S SCHED 40
 180° RETURN: C/S SCHED 40
 OTHER MATERIALS AVAILABLE ON REQUEST