

SSR 350NB - 600NB

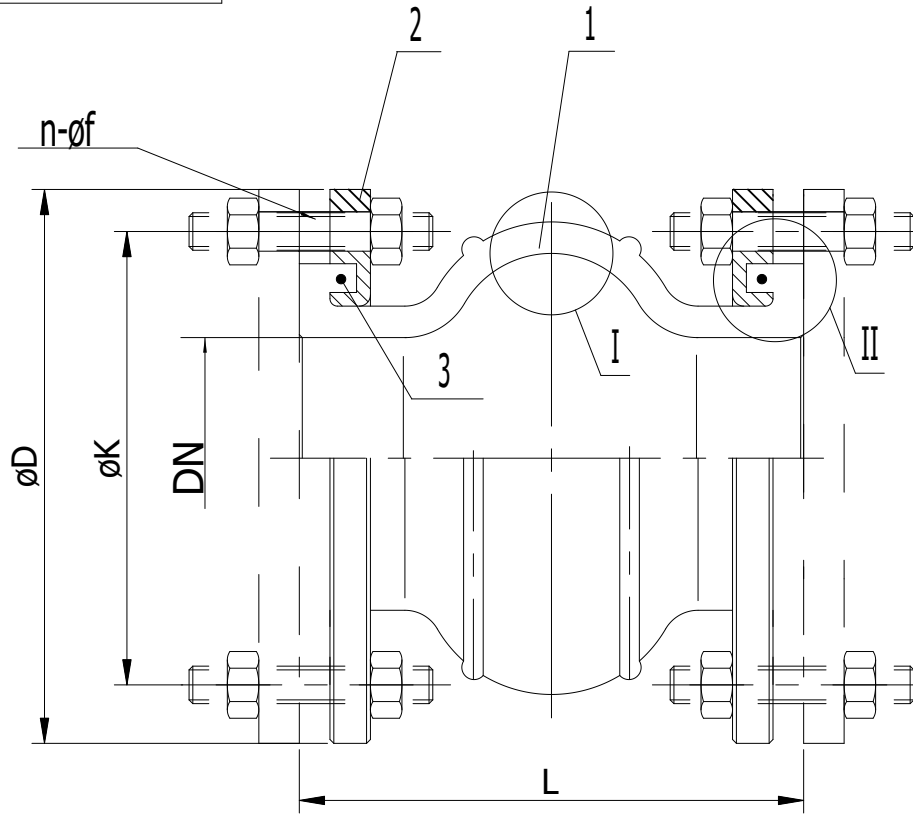

Performance Specification		
Nominal Pressure		1.0
Test	Strength Test	1.5
	Back Seal Test	1.2
	Seal Test	1.2
	Gas Seal Test	0.6
Pressure		Mpa
Maximum Working Temp.		100 °C
Medium: Water, Acid, Sea Water, Alkaline and Coal Cinder, etc.		

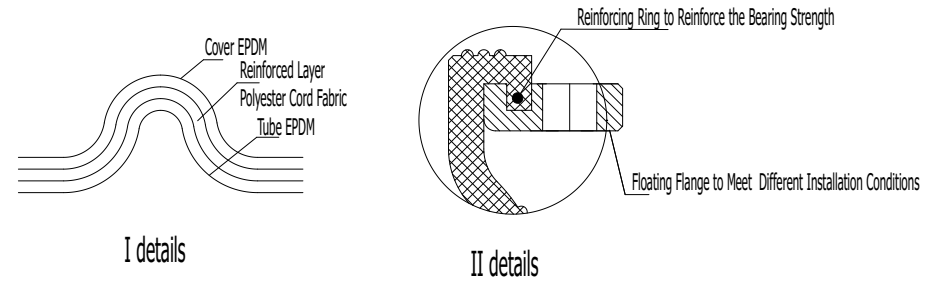

All dimensions in mm.

MARKER	REVISE	REVISION	SIGNATURE	DATE

NO.	DN	ØD	ØK	n-f	L	PN	Axial Compression	Axial Extension	Lateral Displacement	Angular Degree
1	350	505	460	16-ø23	255	10	25	16	22	7.5°
2	400	565	515	16-ø26	255	10	25	16	22	7.5°
3	450	615	565	20-ø26	255	10	25	16	22	7.5°
4	500	670	620	20-ø26	255	10	25	16	22	7.5°
5	550	730	675	20-ø30	260	10	25	16	22	7.5°
6	600	780	725	20-ø30	260	10	25	16	22	7.5°

3	Reinforced Ring	2	Carbon steel			
2	Flange	2	Carbon steel			Galvanized
1	Rubber Bellow	1	EPDM			
NO.	PART NAME	QTY.	MATERIAL	UNIT WEIGHT	TOTAL WEIGHT	REMARK



Engineered Solutions Ltd.

Unit 1, Heol Cropin, Dafen Park, Llanelli
 SA14 8QW Wales UK
 Tel: +44(0)1554 744500
 Fax: +44(0)1554 746435

MARKER	QTY	WEIGHT	SCALE
			1:2.5

Rubber Expansion Joint

SSR 350NB - 600NB