

**Specification:**

**Working Pressure:** 17 Bar(250psi)

**Working Temperature:** -20 Degree C to 90 Degree C

**Application:** hot water storage tanks, water and air conditioners, processing tanks, steam, gas, and water piping ect.

**Standards:**

**Thread:** NPT thread as per ASME B1.20.1/ G thread as per ISO 228/1

**Solder :** ASME B16.18

**Material**

No.	Part Name	Material
1	Steel Nut	Forged Steel
2	Plastic Sleeve	Nylon
3	Brass/Steel Tailpiece	Forged Brass / Steel
4	Rubber Washer	NBR
5	Steel Tailpiece	Forged Steel

**F x M Series DU---Steel Female NPT/G Thread x Brass Male NPT/G Thread**

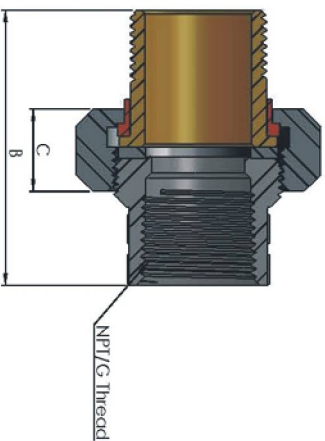
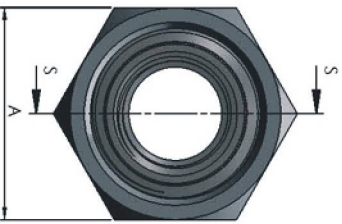

Item No.	Size	A <sub>mm</sub>	B <sub>mm</sub>	C <sub>mm</sub>	Thread
DU050FM	1/2"	36	61	19.5	1/2"
DU075FM	3/4"	41	64	19.5	3/4"
DU100FM	1"	48	72	20	1"
DU125FM	1-1/4"	58	79	23.5	1-1/4"
DU150FM	1-1/2"	70	83	25	1-1/2"
DU200FM	2"	89	87	28	2"

